

Recommendations for using the new Gradient User Interface Style

A new optional, updated user interface was made available with the SelectSite/HigherMarkets 8.2 release. The new user interface style (Gradient) is designed to provide a cleaner, more readable application interface for a better end-user experience.

Using the updated interface entails loading additional images and scripts in the browser window. In the event that using the Gradient user interface style causes a **significant increase** in page loading times while browsing in the application, refer to the recommendations listed below to improve performance (speed) encountered:

1. If using **Internet Explorer**, the likely cause of any significant load time increases is due to *browser caching* for the additional images and scripts in the new user interface. To resolve this, make sure the **Do not save encrypted pages to disk** option is turned **off**. See the screenshot below for an illustration of where this option is found. Disabling this option should result in tremendous performance improvement while accessing any secure site. If there are security concerns around disabling this setting, the **Empty Temporary Internet Files folder when browser is closed** option can be enabled (turned on). This setting, which is located just below the first option, clears the browser cache when the browser is closed.

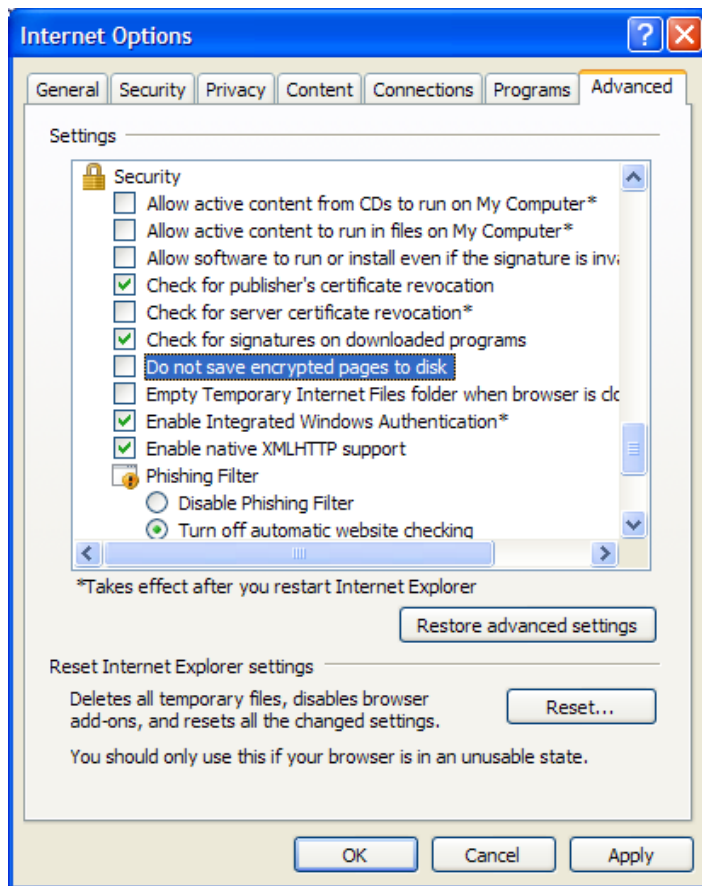

2. If using Internet Explorer, the following adjustments can be result in increased browser performance:
 - a. Set browser to automatically cache files:
 - i. Click on the **Tools** menu, and select **Internet Options**. The **General** tab displays. In the **Temporary Internet Files** section, click the **Settings** button. The option to **Check for newer versions of stored pages:** should be set to **Automatic**.
 - b. Clear temporary files already in the browser's cache:

- i. Click on the **Tools** menu, and select **Internet Options**. The **General** tab displays. In the **Temporary Internet Files** section, click the **Delete Files...** button. Click **Ok**, then **Ok** again.
3. **Use Firefox 3.x or Internet Explorer 7.** In general, these browsers exhibit better caching performance than others and are recommended for use with the new interface style.
4. **Use the original (Classic SciQuest) user interface style.** If you are unable to implement either of the options above or still encounter significant increases in page load times, you can revert back to the original user interface. This setting can be enabled at the organization-wide level in via the *Organization Setup navigation tab -> System sub-tab -> Personal Preferences section*. The user interface style can also be set at the individual level via the user *Profile -> User Settings -> Personal Settings -> User Interface Style*.